

- **Exercise 2.7.** In technical isometry, construct the rotary object (hemisphere and cylinder of revolution) given by its orthogonal projection in scale 1:1. Measure all dimensions you need. Indicate the visibility. Centre A of the hemisphere lies at origin O , the axis of revolution is identical with
- x -axis, choose solution for $x_B < 0$,
 - z -axis, choose solution for $z_B < 0$,
 - y -axis, choose solution for $y_B > 0$.

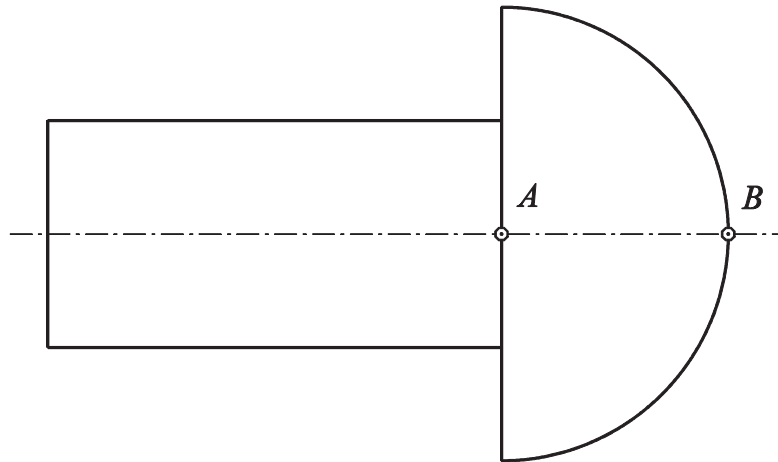

a)

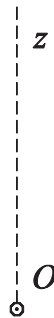

b)



c)

